

OPERATING INSTRUCTIONS FOR MINI-SPLIT UNITS



HEAT PUMP MODELS

9H49YIMI
12H49YIMI
12H49ZIMI
18H49ZIMI
24H47ZIMI

TABLE OF CONTENTS

USER INSTRUCTIONS.....	1
PARTS IDENTIFICATION.....	2
DISPLAY PANEL.....	3
OPERATING TEMPERATURE.....	4
EMERGENCY OPERATION.....	4
AIRFLOW DIRECTION CONTROL.....	5
CARE AND MAINTENANCE.....	6
USING THE REMOTE CONTROL.....	7
LCD INDICATORS.....	8
REMOTE CONTROL OPERATION.....	10
USE OF THE REMOTE CONTROL.....	11
AUTO OPERATION.....	11
COOLING/HEATING/FAN OPERATION.....	11
DRY (DEHUMIDIFYING).....	12
SWING OPERATION.....	12
TIMER OPERATION.....	13
SLEEP OPERATION.....	14
OPERATION TIPS.....	15
TROUBLESHOOTING TIPS.....	16
WARRANTY.....	17
TECHNICAL ASSISTANCE.....	17

USER INSTRUCTIONS AND INFORMATION

In this manual, you will find safety information for operating your new unit. For your safety and the safety of others, please read and understand all cautions located throughout this manual. Retain this manual for future reference.

WARNINGS AND CAUTIONS

Please read the instruction manual prior to use to ensure proper operation of your unit. Installation to be performed by a licenced technician and/or electrician.

INSTALLATION

These units are not intended to be a primary source of heating.

These units are not designed to be installed in the following locations:

- In areas where there is a possibility of combustible gases or fumes.
- In a corrosive atmosphere.
- In damp or moist areas.

Always use correct size wiring and circuit breaker or fuse. Failure to do so may cause fire.

OPERATION

- Always turn the unit to the “OFF” mode with the remote control. Never use a circuit breaker or fuse as a means to turn the unit off and on except in the case of repair.
- Do not operate this unit if you are wet or have wet hands. Electric shock can occur.
- Do not spray insecticides, paints, or other flammable sprays or liquids into or around the unit.
- Do not put foreign objects into the unit.
- Do not hang or place items on the unit.
- Do not use harsh chemicals such as paint thinner, benzene, or polish to clean the unit.
- During cooling operation, shades, blinds, and curtains should be used to shade the room from direct sunlight.



Do not dispose this product as unsorted municipal waste.
Collection of such waste for special treatment is necessary.

PARTS IDENTIFICATION

Indoor unit

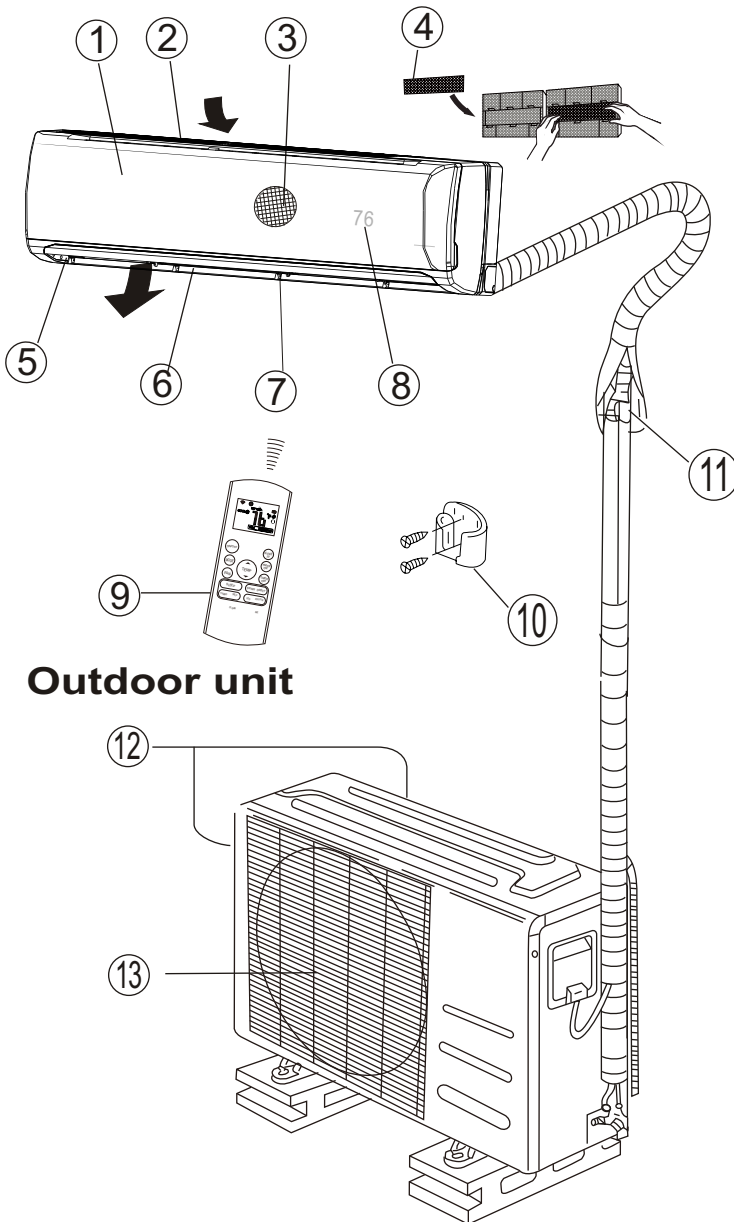

Indoor unit

1. Front panel
2. Air inlet
3. Air filter (under cover)
4. Air freshening filter (on the front of part 3)
5. Air outlet
6. Horizontal air flow grille
7. Vertical air flow louver
8. Display panel
9. Remote control
10. Remote holder

Outdoor unit

11. Connecting pipe, drain hose
12. Air inlet (side and rear)
13. Air outlet

NOTE:

All the pictures in this manual are for explanation purpose only. Your air conditioner may be slightly different.

DISPLAY PANEL

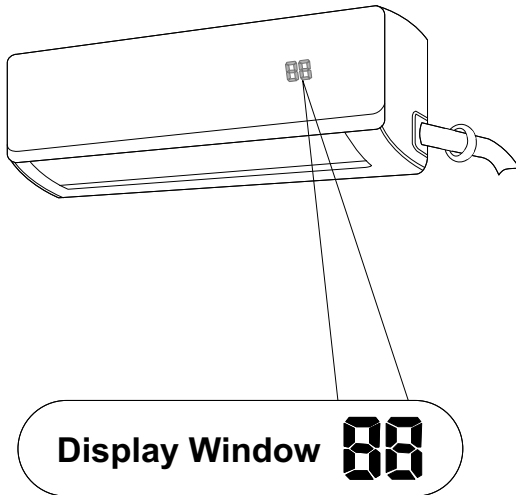

NOTE:

The indoor unit will normally display the set point temperature unless the "FAN" mode is selected. If the "FAN" mode is selected the display will indicate actual room temperature.

Operating Symbols Displayed in Panel

- ON** illuminates for 3 seconds when:
- TIMER is activated.
 - SWING, TURBO, or SILENCE features are turned on.
- OF** illuminates for 3 seconds when:
- TIMER is deactivated.
 - SWING, TURBO, or SILENCE features are turned off.
- cF** illuminates when anti-cold air feature is turned on.
Check detail for the Indoor Fan Operation on page 15.
- dF** illuminates when unit is defrosting.
Check detail for the defrosting Operation on page 15.
- SC** illuminates when unit is self-cleaning.
Check detail explanation on page 9.
- FP** illuminates when freeze protection is turned on.
Check detail explanation on page 9.
- 88** temperature setpoint
- Displays "Set Point" in the following modes:
 - Auto, Cool or Heat
 - Displays "Actual Room Temperature" in the Fan mode.

NOTE: There will not be a visible display on the front cover when the unit is off. The LED's are on the backside of the cover and shine through the cover to create the display when the unit is on.

OPERATING TEMPERATURE

Mode Temperature	Cooling operation	Heating operation	Drying operation
Selectable temperature	62 °F ~ 90 °F	32 °F ~ 86 °F	50 °F ~ 90 °F
Outdoor temperature	5 °F ~ 122 °F	5 °F ~ 86 °F	32 °F ~ 122 °F

CAUTION:

1. If the outdoor temperature conditions are outside the suggested operating range, certain safety and protection features (error codes) may cause the unit to malfunction or stop operating.
2. If fully opened in the maximum downward position for long periods of time, condensate may drip from unit in the Cool or Dry mode.
3. Optimum performance will be achieved when operating in the specified temperature range.

EMERGENCY OPERATION

Emergency operation can be used temporarily in case of lost remote control or low battery.

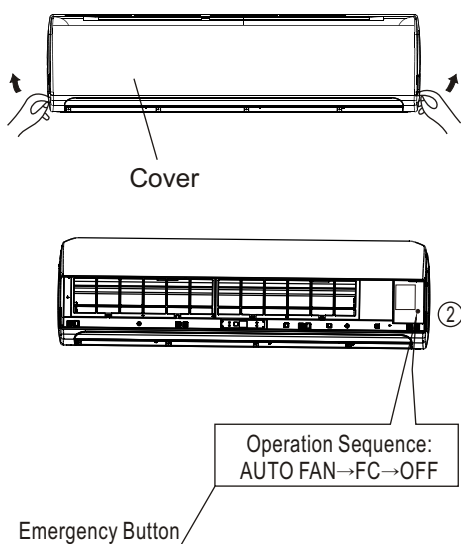

- ① Lift the front panel up until it remains fixed with a clicking sound.
- ② Push the button 1 time, "run" indicator lights up, the unit will work in forced AUTO FAN mode (the default setting temperature is 76 °F).
- ③ Press button within 5 seconds and the unit will activate the Forced Cool function. This will operate the system in cooling for a limited time (up to 1/2 hour). This can be helpful for charging with refrigerant and service.
- ④ Press again to turn the unit off.
- ⑤ Close the panel firmly to its original position.

NOTE:

To restore the remote control operation, use the remote control directly.

AIRFLOW DIRECTION CONTROL

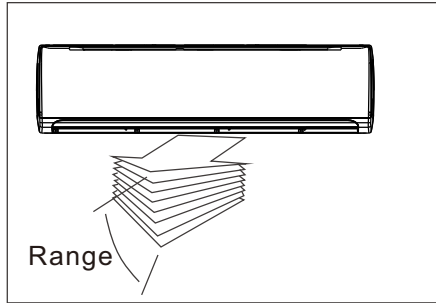

- Adjust the horizontal louver using the remote control.
- Adjust the vertical louver manually.

Setting the air flow direction (Up-Down)

Perform this function while the unit is in operation.

Use the remote controller to adjust the air flow direction.

The horizontal louver can be moved at an angle of 6° for each quick press or hold down SWING button (3 seconds) to set to auto SWING. Please refer to the REMOTE CONTROL section for more details.

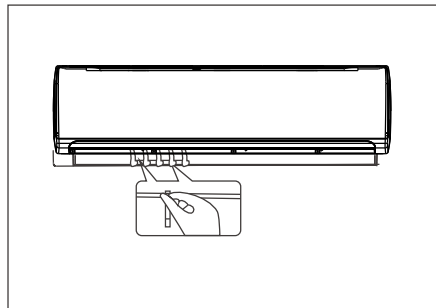

Setting the air flow direction (Left-Right)

Adjust the vertical louver manually by reaching through the horizontal louvers and gently position the louver to desired position.

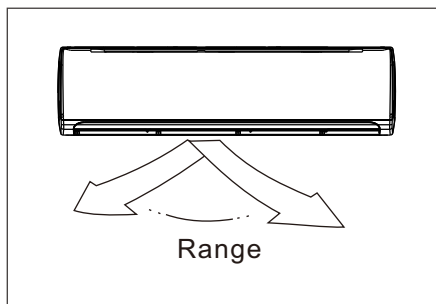

⚠ CAUTION

- If fully opened in the maximum downward position for long periods of time, condensate may drip from unit in the Cool or Dry mode.
 - Do not move the horizontal louver manually. Always use the SWING button. If you move this louver manually, it may damage the louver. If the louver malfunctions, stop the unit and restart it. When the unit is started immediately after it was stopped, the
 - horizontal louver might not move for approximately 10 seconds. Open angle of the horizontal louver should not be set too small,
 - as COOLING or HEATING performance may be impaired due to restricted air flow.
- Do not operate unit with horizontal louver in closed position.
- When the unit is initially connected to power, the horizontal
 - louver may generate a sound for about 10 seconds, this is normal.

CARE AND MAINTENANCE

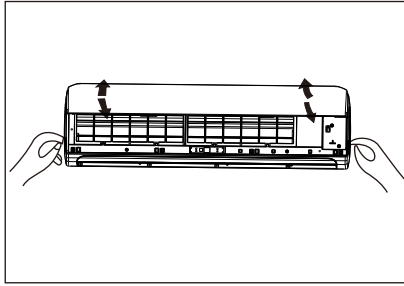

Beginning of Season:

PRIOR TO OPERATION

- Carefully inspect both indoor and outdoor unit for blockages of the inlet and outlet exhaust vents.
- Inspect ground connection. Ensure that ground wire is properly connected.
- Inspect Air Filters and clean if necessary.
- Install new batteries in the remote control unit (2 ea. "AAA").

During the Season:

CLEANING THE AIR FILTERS

Filters should be cleaned every 2 weeks or more often if the unit is used continuously or the unit is operated in a dusty environment.

TO REMOVE THE AIR FILTERS

Open the indoor unit by pressing on the outside edges of the lower corners of the cover and pull outwards. The front cover will swing upwards and snap in the up position.

**DO NOT OPEN FRONT COVER FURTHER THAN STOPS.
DO NOT FORCE THE FRONT COVER OPEN.**

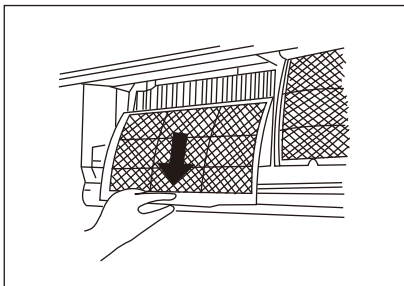
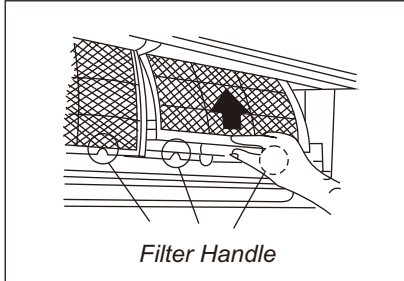

To remove the filters, push the filter upwards from the bottom to release.

Clean the filters by washing in lukewarm water (about 86°F). Allow the filters to dry before re-installing.

DO NOT USE HOT WATER OR HARSH CHEMICALS.

Re-install clean filters by sliding the filter in at the top then locking behind tabs on the bottom.

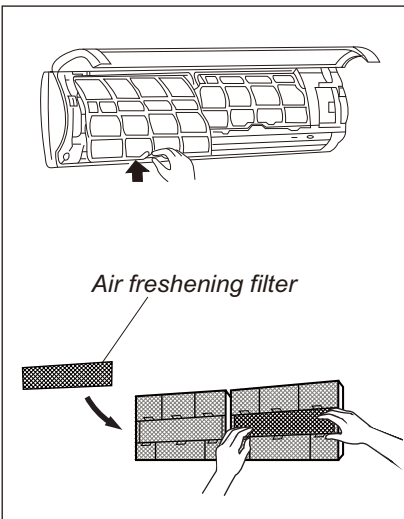

**DO NOT OPERATE THE UNIT WITHOUT THE FILTERS IN PLACE.
DAMAGE TO THE UNIT COULD OCCUR.**

NOTICE: Performance of this unit is greatly reduced when operated with dirty, damaged, or clogged filters.

After the operating season:

Set the temperature to 86°F and operate the unit in the FAN MODE for about 4 - 6 hours to thoroughly remove any moisture from the interior of the unit.

Turn the unit off.

Clean and re-install the air filters.

Clean both the indoor and outdoor units.

Remove batteries from the remote control and store it in a safe place.

USING THE REMOTE CONTROL

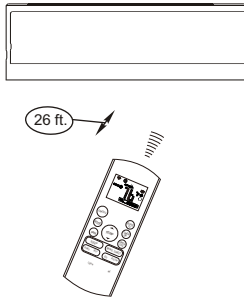

The remote control can be used from a distance up to 26 feet from the indoor unit. When pressing a button on the remote, confirmation the command sent has been received is when the unit beeps.

CAUTIONS

- The air conditioner will not operate if curtains, doors or other materials block the signals from the remote controller to the indoor unit.
- Prevent any liquid from falling into the remote controller. Do not expose the remote controller to direct sunlight or heat.
- If the infrared signal receiver on the indoor unit is exposed to direct sunlight, the air conditioner may not function properly. Use curtains to prevent the sunlight from falling on the receiver.
- If other electrical appliances react to the remote controller, either move these appliances or consult your local dealer.
- Do not drop the remote controller. Handle with care.
- Do not place heavy objects on the remote controller, or step on it.

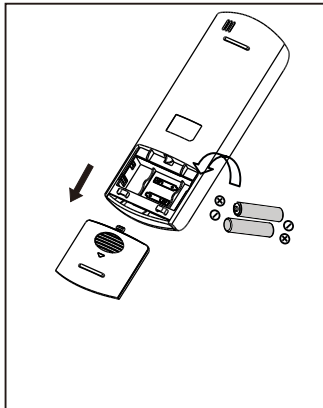

REPLACING THE BATTERIES

The remote control is powered by 2 AAA batteries (included) and housed in the back of the remote control.

- Turn the remote over and remove the cover by pressing and sliding off.
- Remove the old batteries and insert new batteries in the same direction as the old batteries came out.
- Replace the cover.
- When replacing batteries, do not mix old and new batteries or types of batteries.
- Remove batteries if the remote control will not be used for an extended time.
- Please dispose old batteries properly.

NOTE: When the batteries are removed, all programming is erased.
After installing new batteries the remote must be reprogrammed.

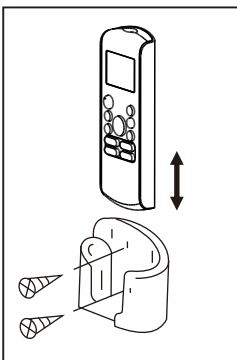

USING THE REMOTE CONTROL HOLDER

- The remote control can be attached to a wall or pillar by using a remote control holder.
- Install the remote control holder with two (2) screws..
- For installing or removing the remote controller, move it up or down in the holder.

REMOTE CONTROL FEATURES

1. Operating mode: AUTO, COOL, DRY, HEAT and FAN.
2. 24 hour Timer On and Timer Off functions.
3. Indoor setting temperature range: 62 °F ~ 86 °F.
4. FOLLOW ME function.
5. SELF CLEAN function.
6. Freeze Protection function.

LCD INDICATORS

Icons are displayed when the remote control is powered on.

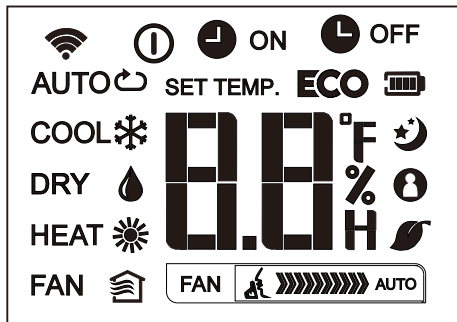

Mode display

AUTO COOL DRY
HEAT FAN

-
- Displayed when data transmitted.
 - Displayed when remote controller is ON.
 - Battery display(low battery detection)
 - ECO** Not available for this unit
-

- ON Displayed when TIMER ON time is set.
- OFF Displayed when TIMER OFF time is set.

Show set temperature or room temperature, or time under TIMER setting.

- Displayed in Sleep Mode operation.
 - Indicated that the air conditioner is operating in Follow Me mode
 - Not available for this unit
 - Displayed in Silence operation.
-

Fan speed indication

- FAN Low speed
 - FAN Medium speed
 - FAN High speed
 - FAN Auto fan speed
-

NOTE:

All indicators shown in the figure are for the purpose of clear presentation. But during the actual operation only the relative functional signs are shown on the display window.

REMOTE CONTROL OPERATION

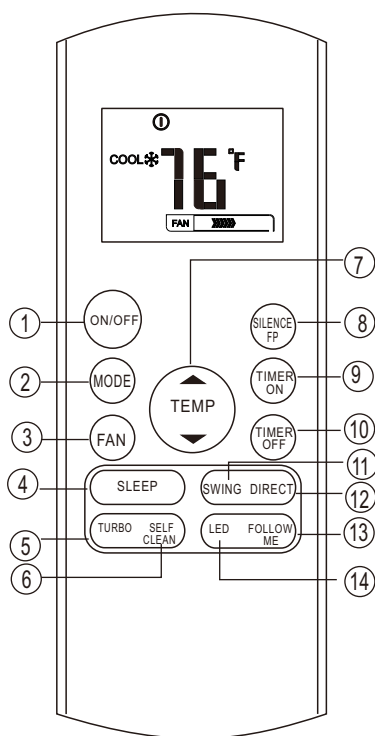

NOTE:

- When changing functions, please allow 3 - 4 minutes for the condenser unit to restart.
The DEFROST icon will illuminate during this period.
- Remote communication distance is within 26 feet.

1 ON/OFF Button

Operation starts when pressed and stops when pressed again.

2 MODE Button

Each time the button is pressed, the operation mode is selected in the following sequence:

AUTO → COOL → DRY → HEAT → FAN

3 FAN Button

Used to select the fan speed in four steps:

AUTO → LOW → MED → HIGH

When in "AUTO" setting, the fan will run faster the further away from the set point it gets. On the other hand the closer it gets to the set point the slower it will run.

NOTE: You can not switch the fan speed in AUTO or DRY mode.

4 SLEEP Button

- Active/Disable sleep function. It can maintain the most comfortable temperature and save energy. This function is available on COOL, HEAT or AUTO mode only.
- For the detail, see sleep operation on page 14.

NOTE: While the unit is running under SLEEP mode, it would be cancelled if MODE, FAN SPEED or ON/OFF button is pressed.

5 TURBO Button

Active/Disable Turbo function. Turbo function enables the unit to reach the preset temperature at cooling or heating operation in the shortest time. Turbo fan will operate for 1/2 hour, then return to previous fan speed.

6 SELF CLEAN Button

Active/Disable Self Clean function. This function can only be activated in the COOL or DRY modes.

Under SELF CLEAN mode, the air conditioner will automatically clean and dry the Evaporator and keep it as fresh for the next operation. "SC" shows on the display window of panel while this feature is activated.

The Self Clean function will last approximately 16 minutes.

7 UP Button (▲)

Press this button to increase indoor temperature. Increments 1°F each press.

DOWN Button (▼)

Press this button to decrease indoor temperature. Decrements 1°F each press.

NOTE: Temperature control is not available in Fan mode.

°F or °C

Press and hold UP and DOWN buttons together for 3 seconds will alternate the temperature display between the °F or °C scale.

8 SILENCE/FP(Freezen Protection) Button

- Active/Disable SILENCE function.

When the Silence function is activated, the compressor will operate at low frequency and the indoor unit will bring faint breeze, which will reduce the noise to the lowest level and create a quiet and comfortable room for you.

NOTE: Due to low frequency operation of compressor, it may result in insufficient cooling and heating capacity.

- Press and hold this button for 2 seconds to automatically set heat to 46°F (must be in heat mode). "FP" shows on the display window of panel. It is good for extended times away from home. Keeps pipes from freezing while occupants are away. Press the buttons of ON/OFF, SLEEP, FP, MODE, FAN SPEED, UP or DOWN while operating will cancel the FP function.

REMOTE CONTROL OPERATION

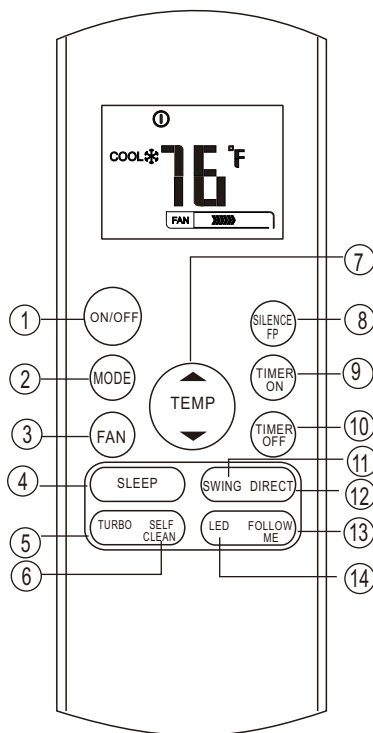

9 TIMER ON Button

Press this button to initiate the auto-on time sequence. Each press will increase the auto-timed setting in 30 minutes increments. When the setting time displays 10.0, each press will increase the auto-timed setting 60 minutes increments. To cancel the auto-timed program, simply adjust the auto-on time to 0.0.

10 TIMER OFF Button

Activates the Auto-Off time setting. Each press will increase the time setting by 30 minutes up to 10 hours, then 1 hour increments up to 24 hours. To cancel press the button until it reads 00:00.

11 SWING Button

Used to stop or start horizontal louver auto swing continuously.

12 DIRECT Button

Stops or starts the louver movement and to set the desired up/down airflow direction. The louver changes 6° in angle for each press.

13 FOLLOW ME Button

Press the this button to activate the FOLLOW ME function. This allows the room temperature sensing to be transferred from the wall unit (evaporator) to the remote control. When the FOLLOW ME button is pressed the remote control display will indicate actual room temperature and the wall unit will display set point temperature.

NOTE:

The remote control will communicate with the indoor unit every 3 minutes interval until press the Follow Me button again to disable the function. The air conditioner will cancel the Follow Me feature automatically if it does not receive the signal during any 7 minutes interval.

14 LED Button

Press the LED button to turn off the indoor panel from illuminating. The remote is still fully functional but the indoor unit will not be illuminated.

If a button is pressed to make a change, the change will be illuminated for 10 seconds in the panel.

NOTE:

The "Beep" of signal received from the remote control for each press will be turned off while the LED display blanked.

USE OF THE REMOTE CONTROL

AUTO OPERATION

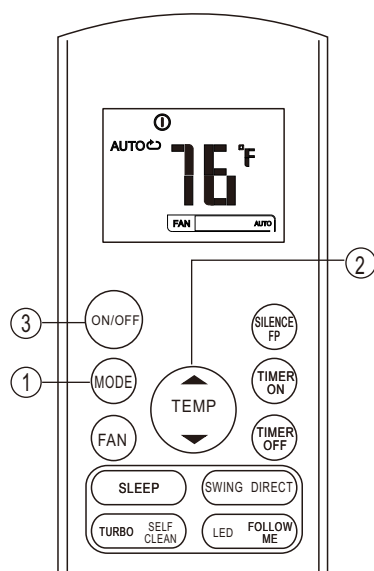

- 1) Press the MODE button to select AUTO.
- 2) Press the TEMP (▲▼) to adjust the temperature setting. The temperature can be set to 62 °F ~ 86 °F in 1°F increments.
- 3) Press the ON/OFF button to start the unit. The AUTO icon will illuminate.
- 4) Display will indicate "Set Point".

NOTE:

In the AUTO mode the function will automatically change from HEAT-COOL-FAN depending on temperature.

In the AUTO mode, you cannot change the fan speed. It has been pre-programmed.

COOLING/HEATING/FAN OPERATION

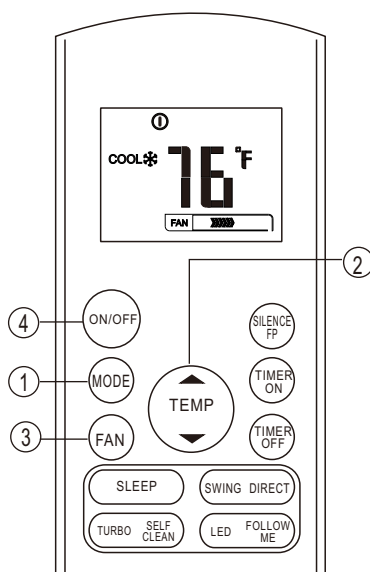

- 1) Press the MODE button to select COOL, HEAT (Heat Pump models only) or FAN mode.
- 2) Press the TEMP (▲▼) (to adjust the temperature setting. The temperature can be set to 62 °F ~ 86 °F in 1°F increments. When temperature is changed the display will flash, this is normal.
- 3) Press the FAN SPEED button to select the fan speed in four steps: AUTO, LOW, MED, or HIGH.
- 4) Press the ON/OFF button to start the unit.
 - The icon will illuminate indicating the mode selected.
 - Display will indicate "Set Point" in the Cool or Heat mode.
 - In Fan Mode, the indoor panel display will indicate "Actual Room Temperature" while no temperature displays on the remote control.

NOTE:

- a) In the FAN mode (air circulation only), the setting temperature is not displayed in the remote controller and you are not able to control the room temperature. In this case, only step 1, 3 and 4 may be performed.
- b) When indoor temperature is satisfied in COOLING the compressor will keep running at lowest speed until next call for cooling. If room temperature keeps on dropping, the compressor will turn off finally. The indoor fan keeps operating continuously.
- c) When indoor temperature is satisfied in HEATING the compressor will keep running at lowest speed until next call for heating. If room temperature keeps on rising, the compressor will turn off finally. The indoor fan will continue to operate until the indoor unit coil temperature has decreased - the indoor fan will then turn off.
- d) When the unit is in DEFROST, "dF" on the front panel of the indoor unit will illuminate and the indoor fan will turn off.
- e) Heat mode: The "dF" will be illuminated until the coil temperature reaches a preset temperature and the indoor fan turns on.

USE OF THE REMOTE CONTROL

DRY (DEHUMIDIFYING)

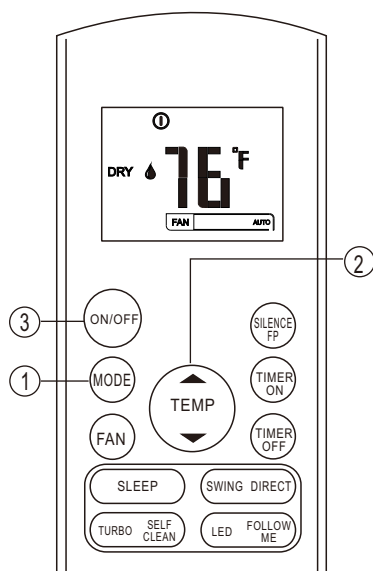

- 1) Press the MODE button to select the DRY mode.
- 2) Press the TEMP (▲▼) (to adjust the temperature setting. The temperature can be set to 62 °F ~ 86 °F in 1°F increments.
- 3) Press the ON/OFF button to start the unit.
The DRY icon will illuminate and the unit will operate at LOW fan speed.
Push the ON/OFF button again to stop this operation.
- Display will indicate "Set Point" in the Dry mode.

NOTE:

In Dehumidifying (DRY) mode, the fan speed cannot be changed. It has been pre-programmed.

Indoor fan operates at low speed while cooling cycles on and off.

SWING/DIRECT OPERATION

Use the SWING/DIRECT button to adjust the up/down direction of the air.

- 1) Press the DIRECT button to move the louvers up or down by 6° increments.
- 2) Press and hold the SWING button for 3 seconds to put it into automatic swing mode. Pressing it again will stop the auto swing.

NOTE:

The vertical louver (right-left) must be set manually. Grip the deflector rod and manually adjust it to your preferred direction.

- If fully opened in the maximum downward position for long periods of time, condensate may drip from unit in the Cool or Dry mode.
- COOLING or HEATING performance may be impaired due to restricted air flow if the horizontal louver was set downward.

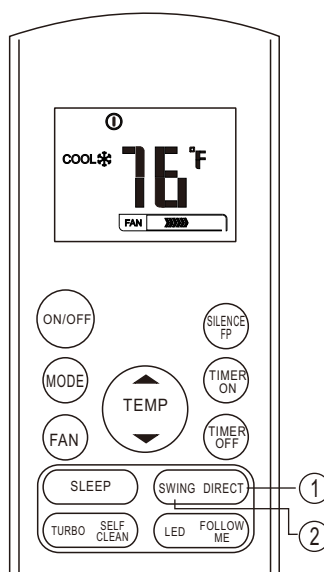

USE OF THE REMOTE CONTROL

TIMER OPERATION

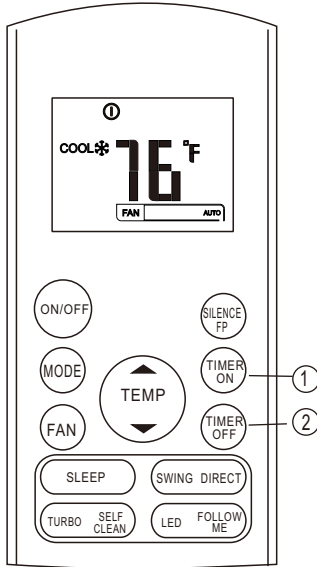

Press TIMER ON button. The remote control shows TIMER ON, the last Auto-On time setting and the icon "H" (hours) is shown on the display. Each press will increase the time setting by 30 minutes up to 10 hours, then 1 hour increments up to 24 hours. To cancel press the button until it reads 00:00 or turn the unit OFF and then back on to clear the timer.

After the signal is transmitted the set temperature and TIMER ON will be displayed on the LCD display.

If the unit is operating when the timer is set, it will turn the unit off until "ON" time has expired and unit will turn on.

Press TIMER OFF button. The remote control shows TIMER OFF, the last Auto-Off time setting and the icon "H" (hours) is shown on the display. Each press will increase the time setting by 30 minutes up to 10 hours, then 1 hour increments up to 24 hours. To cancel press the button until it reads 00:00 or turn the unit OFF and then back on to clear the timer.

After the signal is transmitted the set temperature and TIMER OFF will be displayed on the LCD display.

If the unit is off when the timer is set, it will turn the on until "OFF" time has expired and unit will turn off.

⚠ CAUTION

When you select the timer operation, the remote controller automatically transmits the timer signal to the indoor unit for the specified time. Therefore, keep the remote control in a location where it can transmit the signal to the indoor unit properly.

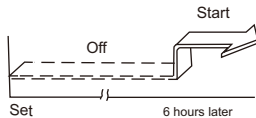
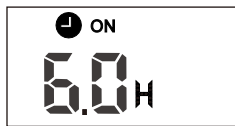

EXAMPLES OF TIMER SETTINGS (TIMER ON OPERATION)

The TIMER ON feature is useful when you want the unit to turn on automatically before you return home. The unit will automatically start operating at the set time.

EXAMPLE:

To start the air conditioner in 6 hours.

1. Press the TIMER ON button, the last setting of starting operation time and the icon "H" will show on the display area.
2. Press the TIMER ON button to display "6.0h" on the TIMER ON display of the remote control.
3. In about 3 seconds the digital display area will show the temperature again. The function is now activated.

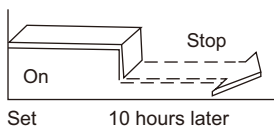

(TIMER OFF OPERATION)

The TIMER OFF feature is useful when you want the unit to turn off automatically after you go to bed. The unit will turn off at the set time.

EXAMPLE:

To stop the unit in 10 hours.

1. Press the TIMER OFF button, the last setting of stopping operation time and the icon "H" will show on the display area.
2. Press the TIMER OFF button to display "10h" on the TIMER OFF display of the remote controller.
3. In about 3 seconds the digital display will show the temperature again. The function is now activated.

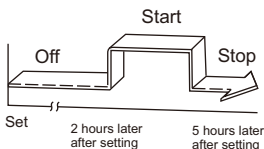
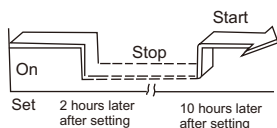

COMBINING TIMERS

(Setting both ON and OFF timers simultaneously)

TIMER OFF => TIMER ON

(On => Stop => Start Operation)

This feature is useful when you want to stop the unit after you go to bed, and start it again in the morning when you wake up or when you return home.

EXAMPLE:

To stop the unit 2 hours after setting and start it again 10 hours after setting.

1. Press the TIMER OFF button.
2. Press the TIMER OFF button again to display "2.0h" on the TIMER OFF display.
3. Press the TIMER ON button.
4. Press the TIMER ON button again to display "10h" on the TIMER ON display.
5. Wait for the remote control to display the temperature setting. The "TIMER ON & TIMER OFF" indicator remains on and this function is activated.

TIMER ON => TIMER OFF

(Off => Start => Stop Operation)

This feature is useful when you want to start the unit before you wake up, and stop it after you leave home.

EXAMPLE:

To start the unit 2 hours after setting and stop it 5 hours after setting.

1. Press the TIMER ON button.
2. Press the TIMER ON button again to display "2.0h" on the TIMER ON display.
3. Press the TIMER OFF button.
4. Press the TIMER OFF button again to display "5.0h" on the TIMER OFF display.
5. Wait for the remote control to display the temperature setting. The "TIMER ON & TIMER OFF" indicator remains on and this function is activated.

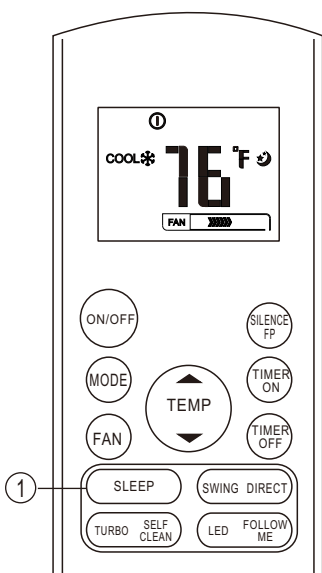

SLEEP OPERATION

When you press the SLEEP button, the sleep feature will be activated. The set temperature will increase (cooling) or decrease (heating) by 2 °F per hour for the first 2 hours, then hold steady for the next 5 hours. The SLEEP icon displays on the LCD.

After the total of 7 hours the temperature set point will automatically return to the original setting.

This feature maintains both energy saving and comfort in the SLEEP operation.

The SLEEP function is only available under COOL, HEAT, and AUTO operation.

OPERATION TIPS

The following events may occur during normal operation.

1. Compressor Protection

The compressor will not restart for 3 to 4 minutes after it turns off. This prevents rapid cycling of the compressor.

2. Indoor Fan Operation

The unit is designed to reduce the possibility of blowing cold air (Anti-Cold Air) in the HEAT mode during one of the three conditions and the set temperature has not been reached.

- a) Initial start up - indoor coil temperature is too low.
- b) Defrost function.
- c) Indoor coil temperature is too low.

Defrost function:

Frost may be generated on the outdoor unit during the heat cycle if the outdoor temperature is low and humidity is high. When this occurs the heat pump will stop the heating operation and start defrosting automatically.

The time to defrost may vary from 4 to 10 minutes according to the outdoor temperature and the amount of frost buildup on the outdoor unit.

3. Mist blowing from the indoor unit

A mist may be generated, in a high humidity environment, due to a large temperature difference between air Inlet and air outlet while in the COOL mode. It may be necessary to raise the set temperature to reduce this condition.

4. Low noise (Indoor Unit)

You may hear a low hissing sound when the compressor is running or has just stopped running. This sound is the sound of the refrigerant flowing or stopping. You may also hear a low noise sound when the compressor is running or has just stopped. This is caused by expansion and contraction of the plastic parts in the unit during temperature changes.

A noise may be heard due to the louver returning to its original position when the unit is first turned on.

5. Dust blowing from the indoor unit.

This is a normal condition when the air conditioner has not been used for a long time or initial start up.

6. Fan cycling - HEAT or COOL modes.

In the cooling mode, indoor fan runs continuously at the selected speed: High, Medium, Low or Auto.

In the heating mode, the indoor fan will continue to run until the indoor coil temperature and the room temperatures are satisfied.

If the compressor stops because the room temperature is satisfied, the indoor fan will continue to run for approximately 2 minutes.

This High Efficiency unit is designed to maintain the selected room temperature by slowing the compressor and refrigerant flow to the indoor unit to reduce the energy consumed by starting the compressor.

7. If fully opened in the maximum downward position for long periods of time, condensate may drip from unit in the Cool or Dry mode.

8. Heating mode

The heat pump produces heat from the outdoor unit and releases it via the indoor units coil during the heating operation. When the outdoor temperature falls, heat drawn in by the heat pump decreases accordingly.

At the same time, the heat load increases due to a larger difference between indoor and outdoor temperatures.

If a comfortable temperature can't be achieved by this unit during colder outdoor temperatures, we suggest you use a supplemental heating device.

9. This unit is not intended as a primary heating source.

10. Auto-restart function

After a power outage and the power is restored, the unit restarts automatically at all previous settings.

11. Lightning strikes or nearby strikes can cause the unit to malfunction and possibly damage internal components.

Turn the unit off with the remote and at the breaker. Wait 3 minutes and turn the power on and restart using the remote.

12. To read room temperature set mode to fan.

13. Outdoor fan speed is controlled to optimize operation.

TROUBLESHOOTING TIPS

Stop the air conditioner immediately if one of the following faults occur.
Disconnect the power and contact your qualified service technician.

Trouble	If the following code appears on the LED display, disconnect the power and contact a qualified service technician: E0, E1, E2, E3, E4, E5,E7, EC, F0, F1, F2, F3, F4, F5, P0, P1, P2, P3 and P4.
	Fuse blows or circuit breaker trips frequently - Contact a qualified service technician.
	Water dripping/mist from the unit - See page 15 note #3 and #7. If this does not resolve the problem, it will be necessary to contact a service technician.
	The remote control won't work or works abnormally. There should be an audible beep each time a button is pressed. (replace batteries).
	Other abnormal situations.

Malfunctions	Cause	What should be done?
Unit does not start.	Main power is off.	Restore power.
	Fuse may have blown or breaker tripped.	Replace the fuse or reset breaker. If the condition continues, contact a service technician.
	Batteries in remote control may be low.	Replace the batteries.
	Check to see if timer is set.	Wait or cancel timer setting.
	Interference from cell phone towers and remote boosters may cause the unit to malfunction.	Disconnect the power, then reconnect. Press ON/OFF button on the remote control to restart operation..
Unit not cooling or heating satisfactorily.	Temperature setting.	Set temperature correctly.
	Air filter is blocked.	Clean the air filter.
	Doors and/or windows are open.	Close the doors and/or windows.
	Air inlet or outlet of indoor or outdoor unit has been blocked.	Clear obstructions and restart unit.
	Compressor 3 to 4 minutes protection delay has been activated.	Wait 3 to 4 minutes.
	SILENCE function is activated.	SILENCE function can lower product performance by reducing operating frequency. Turn off SILENCE function.
	Low refrigerant due to leak or long-term use.	Check for leaks, re-seal if necessary and top off refrigerant.

If the trouble has not been corrected, please contact a local authorized service provider.
Inform them of the malfunctions in detail and have unit model number available when calling.
Never attempt to repair the unit yourself. Always consult an authorized service provider.

WARRANTY

International Refrigeration Products warrants the accompanying split air conditioner system to be free of defects in material and workmanship for the applications specified in the operation manual and installation manual for a period of (1) year on parts and five (5) years on the compressor, valid from date of original retail purchase in the United States or Canada. LABOR and SHIPPING are not covered under warranty.

If the unit exhibits a defect in normal use and it is determined to be within the warranty period, International Refrigeration Products will, at its option, either repair or replace the unit free of charge within a reasonable time after the unit is returned.

This warranty DOES NOT cover:

- LABOR, REFRIGERANT or SHIPPING
- Damage, accidental or otherwise, to the unit while in possession of the consumer that is not a result of a defect in material or workmanship.
- Damaged caused by consumer misuse, tampering, or failure to follow all care and maintenance instructions in the manual.
- Damage to the finish of the case or other parts caused by water.
- Damage caused by repairs or alterations to the unit by anyone other than a qualified technician.
- Air Filters
- Freight and insurance cost for the warranty service.

Warranty Activation Card must be completed and sent in to activate the warranty for the accompanying unit. Warranty can also be activated at www.irproducts.biz web site.

Extended Warranty Options Available Through JB Warranties:

For more information go to: <https://partners.jbwarranties.com/irp>

Or scan the QR Code with your Smart Phone



TECHNICAL ASSISTANCE

IF YOU STILL NEED SERVICE:

Please contact the installation contractor, or call International Refrigeration Products at (215) 750-9876 between the hours of 8:00 a.m. and 4:30 p.m. EST , Monday thru Friday.

For faster service, please have the model and serial numbers of both the inside unit and the outside unit available when you call.